

**ADVANTAGE
AIR**

INSTALLATION INSTRUCTIONS FOR
1968-69 CHEVELLE
W/O FACTORY AIR CONDITIONING
(55069-VCZ-A)

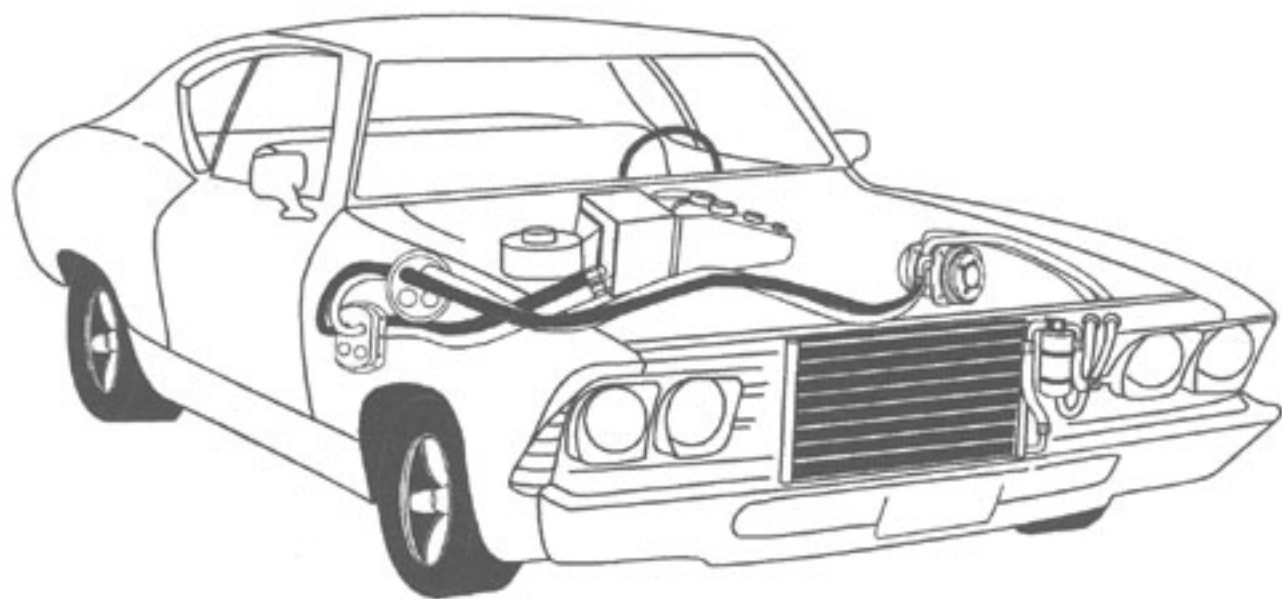

BEFORE STARTING INSTALLATION, CHECK THE FUNCTION OF THE VEHICLE (HORN, LIGHTS, ETC.) FOR PROPER OPERATION. STUDY THE INSTRUCTIONS, ILLUSTRATIONS, AND DIAGRAMS. DISCONNECT BATTERY.

1. REMOVE THE FOLLOWING (FIGURE 1)

1. REMOVE STEERING COLUMN COVER
2. DROP STEERING COLUMN DOWN
3. DROP GAUGE PANEL DOWN
4. REMOVE GLOVE BOX DOOR
5. REMOVE GLOVE BOX(DISCARD)
6. REMOVE OEM SIDE VENTS
7. REMOVE OEM CONTROL PANEL
8. REMOVE PASSENGER SIDE KICK PANEL

9. REMOVE OEM HEATER FIREWALL COVER (INNER FENDER MUST BE LOOSENED & LOWERED DOWN TO ALLOW REMOVAL. NOTE: CAR MAY NEED TO BE JACKED UP SLIGHTLY TO ALLOW ENOUGH SPACE FOR UNIT TO BE REMOVED.)(DISCARD)
10. REMOVE OEM HEATER(DISCARD)
11. REMOVE OEM DEFOST DUCTS(DISCARD)

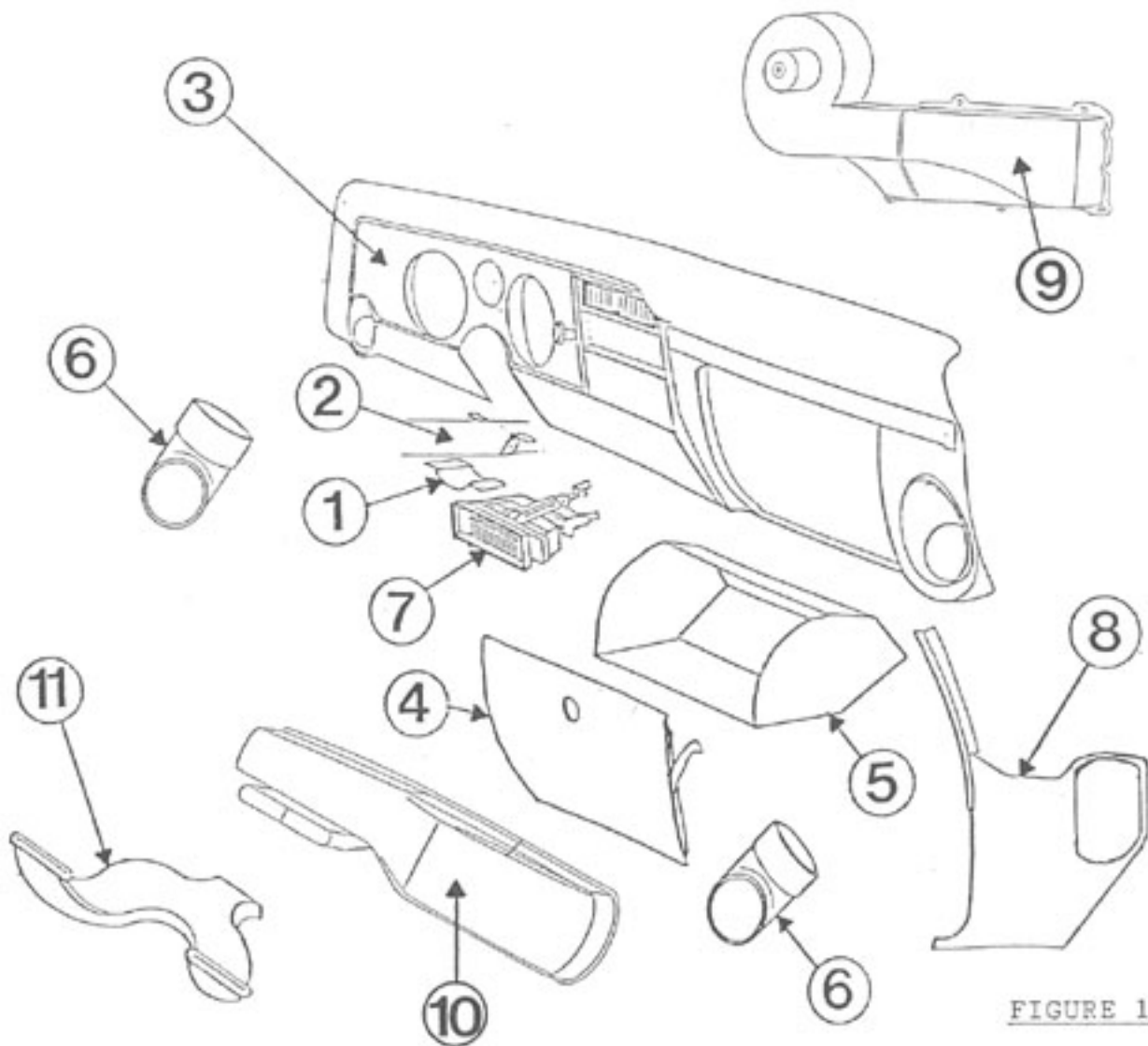
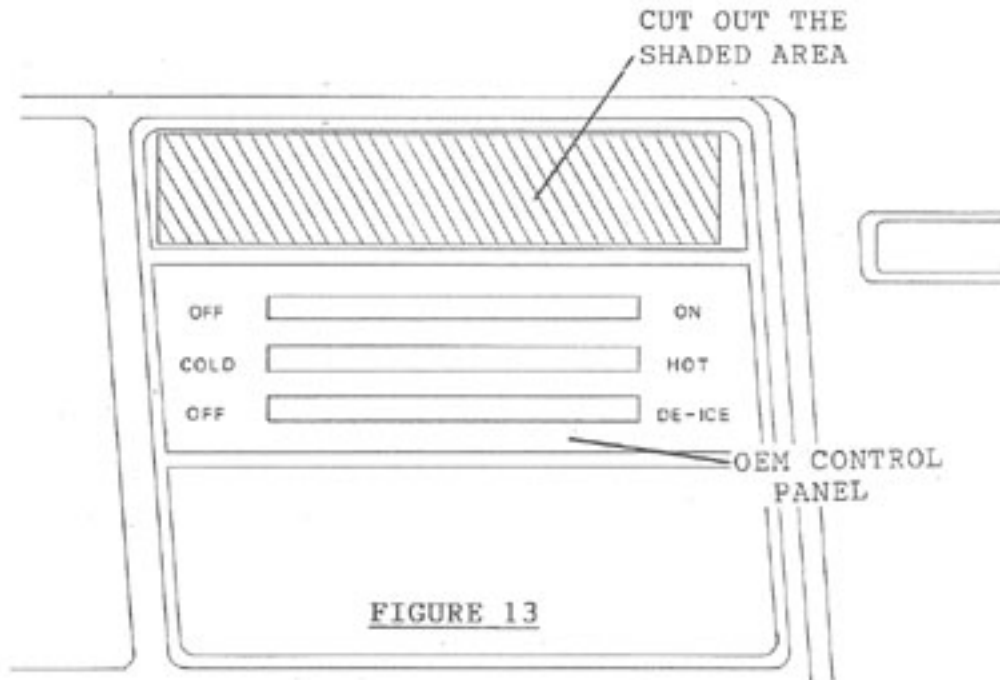

FIGURE 1

CENTER LOUVER INSTALLATION



1. Cut out the center of the panel above the OEM control panel as Figure 13 shows. Use the new center louver assembly (supplied) as a template. Be careful not to cut the hole too big.
2. After the panel is cut out, insert the center louver pod and attach to OEM holes in dash as Figure 13A shows.

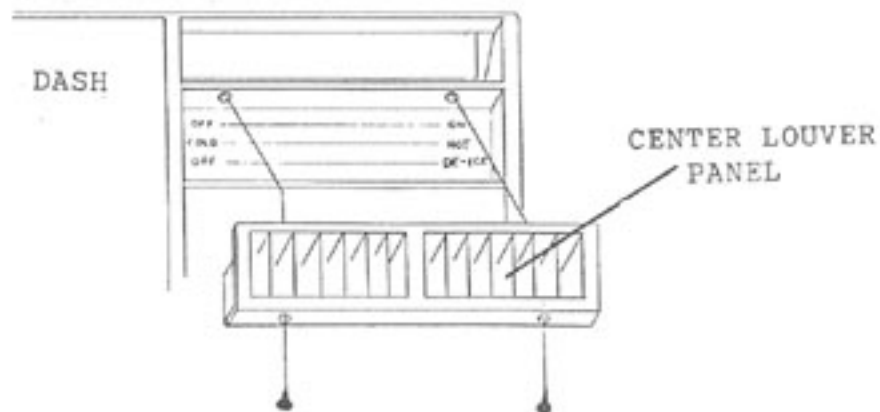
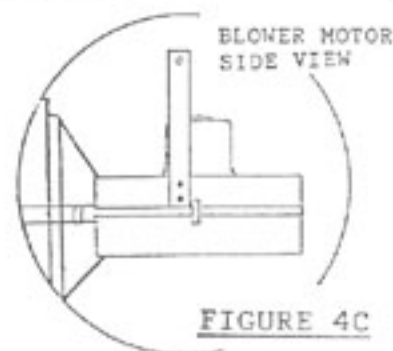
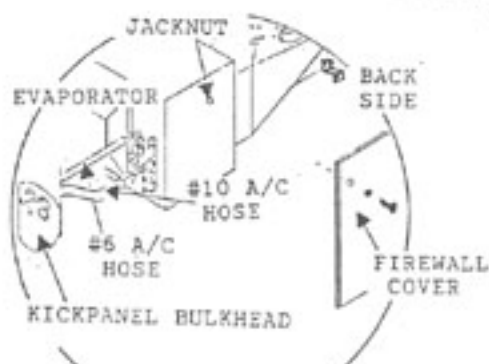
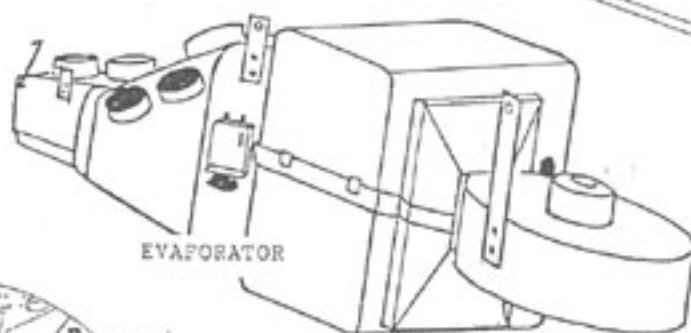
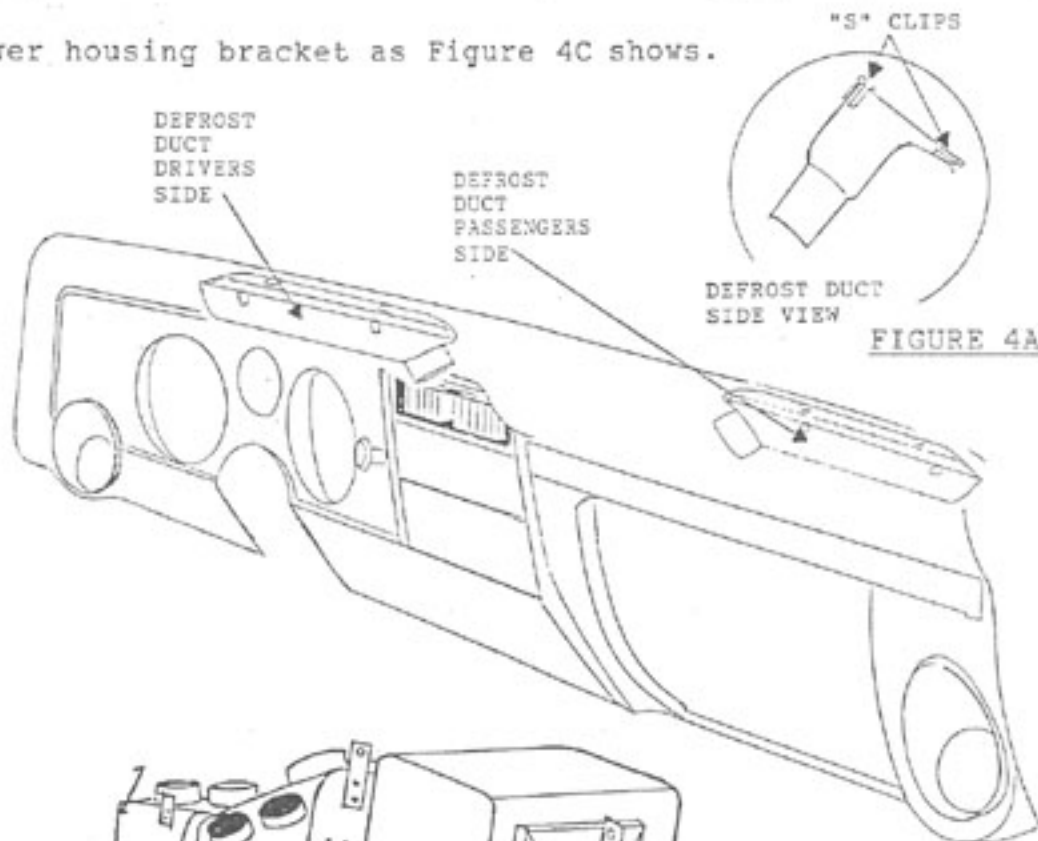

FIGURE 13A

EVAPORATOR INSTALLATION

1. Install defroster ducts on passenger and drivers side as Figure 4 shows and attach to dash vents as Figure 4A shows.
2. Lay the unit on the floorboard and attach #6 & #10 A/C hoses as Figure 4B shows. It is also necessary to install the heater hoses at this time as Figure 12A shows on page 9. The heater hoses pass thru the lower holes in both bulkheads and follow the same routing out of the passenger compartment as the A/C hoses. (Refer to page 9.)
3. Attach blower housing bracket as Figure 4C shows.



4. Raise unit up and position under dash. The back of the unit is supported by a bolt thru the firewall cover (from engine compartment) to the jacknut in the back of the unit as Figure 7A shows.
5. Attach the evaporator bracket directly to the bracing under the dash as Figure 7B shows.
6. Attach the defroster plenum bracket directly to the firewall using a sheetmetal screw (supplied) as Figure 7A shows.
7. Attach the blower housing bracket to the panel under the dash using a sheetmetal screw (supplied) as Figure 7C shows

NOTE: Steps 6 & 7 may require drilling a 1/8" hole to get the screw started. If so, use the location of the bracket as a guide for marking where the holes need to be drilled.

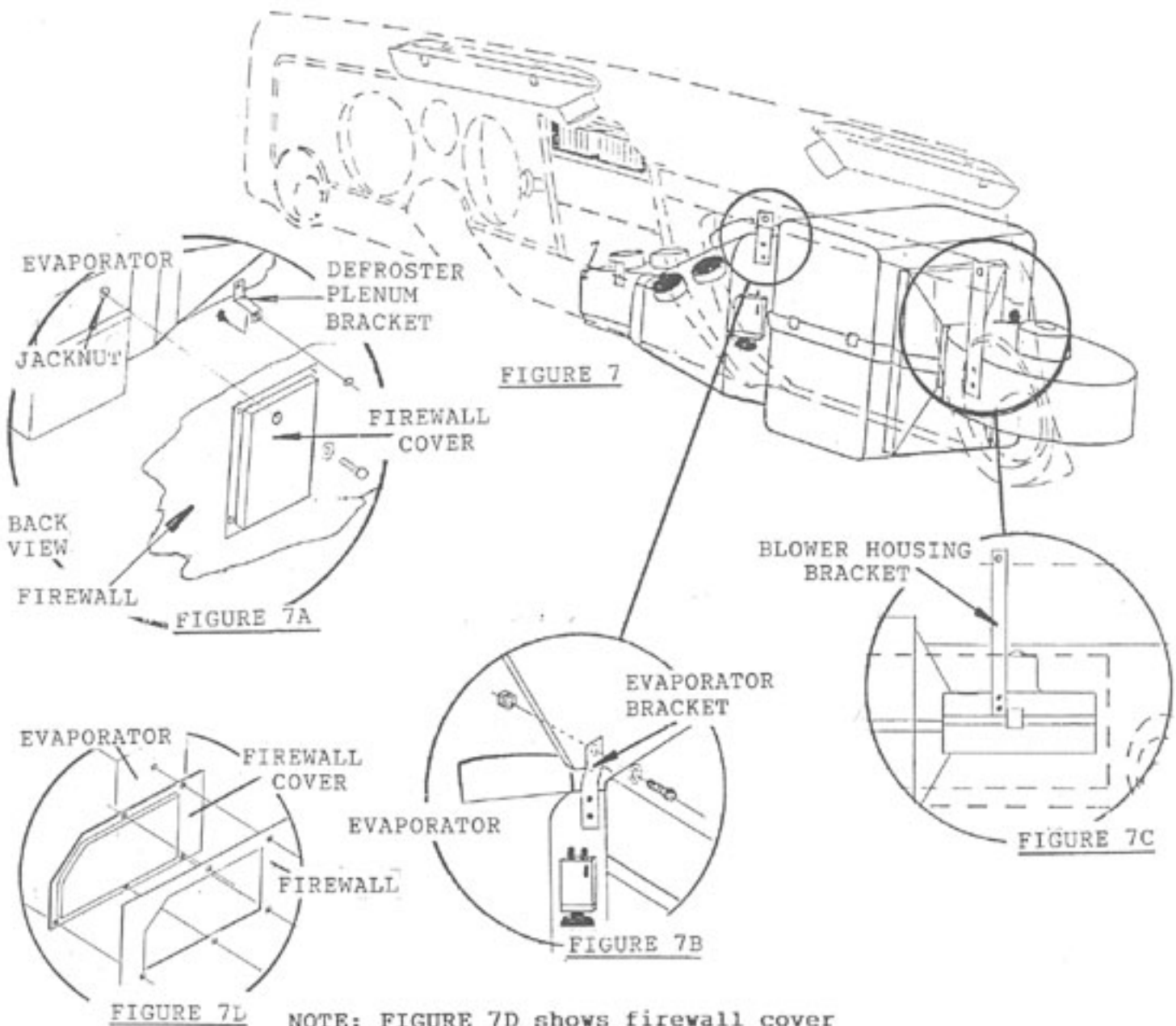

NOTE: FIGURE 7D shows firewall cover installation for cars without a factory air firewall.

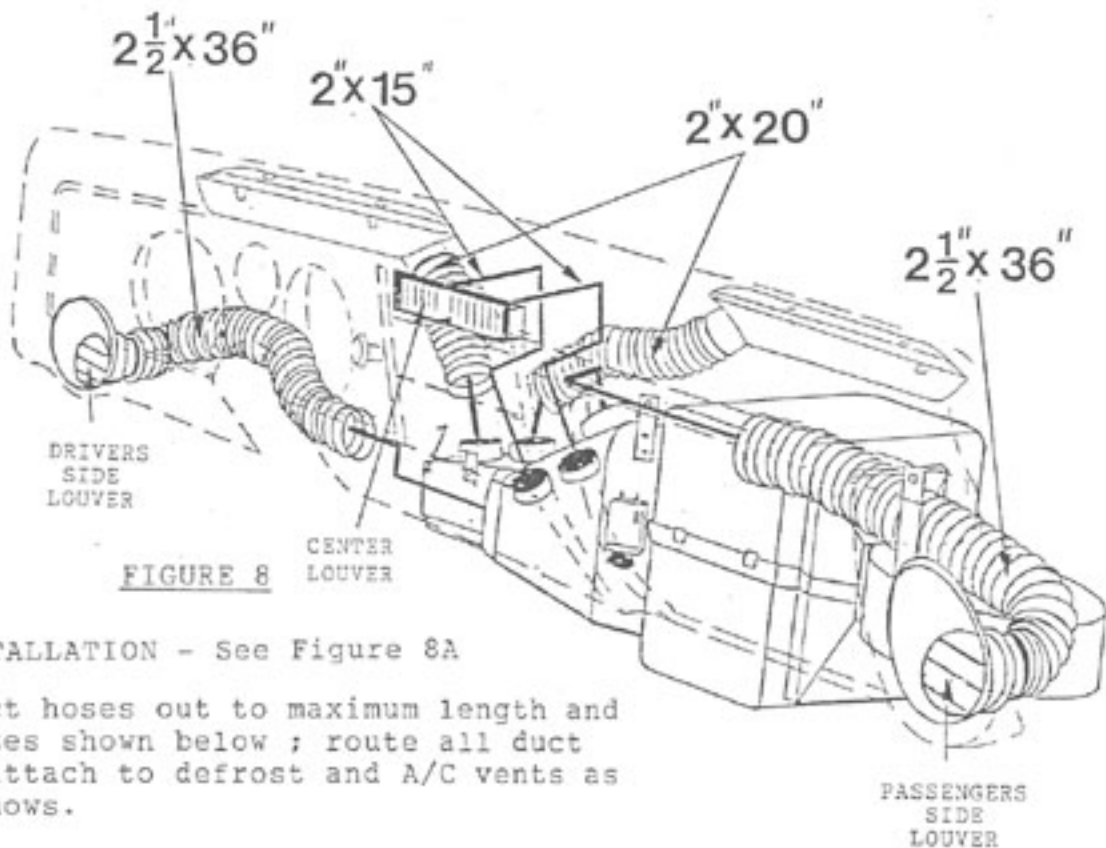

FIGURE 8

8. LOUVER INSTALLATION - See Figure 8A

9. Stretch duct hoses out to maximum length and cut the sizes shown below ; route all duct hoses and attach to defrost and A/C vents as Figure 8 shows.

NOTE: With the unit in place, stretch the duct hoses tightly to their corresponding outlets on unit and recheck the length. Insure that the hose is pulled tightly with a minimum of kinks or sharp bends in the hose. This will insure maximum air flow.

DUCT HOSE LENGTH

DRIVERS SIDE VENT: 2-1/2" X 36"	(1 HOSE)
DRIVERS SIDE DEFROST VENT: 2" X 20"	(1 HOSE)
CENTER LOUVER: 2" X 15"	(2 HOSES)
PASSENGER SIDE DEFROST: 2" X 20"	(1 HOSE)
PASSENGER SIDE VENT: 2-1/2" X 36"	(1 HOSE)

10. Drill a 5/8" hole 1" below the firewall cover and in-line with the drain tube in the bottom of the unit. Insert the 1/2" drain hose thru firewall and attach to drain tube on unit.

HOSE ADAPTER INSTALLATION

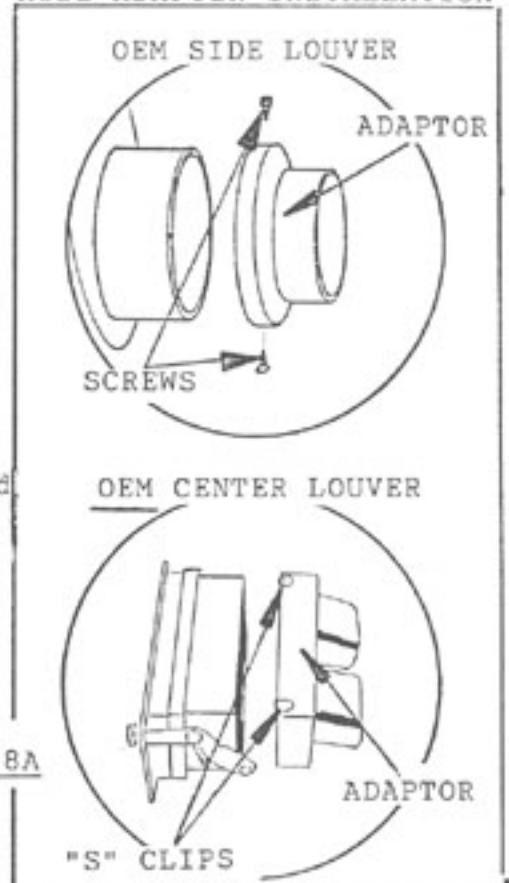

FIGURE 8A

HEATER HOSE INSTALLATION

Install heater hoses and heater valve as Figure 9 shows.

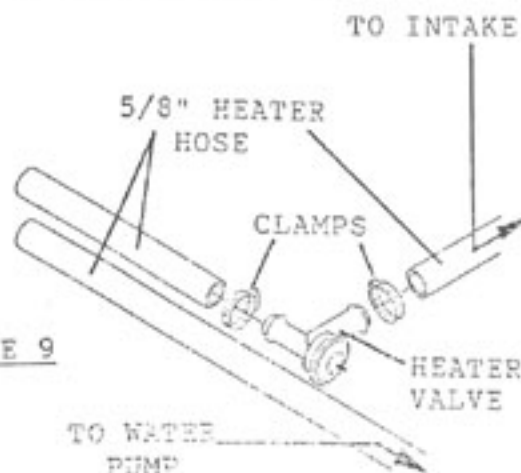

FIGURE 9

PASSENGER SIDE KICK PANEL

Cut just the OEM vent door out of the kick panel as Figure 9A shows. Use the kick panel bulkhead (supplied) as a template.

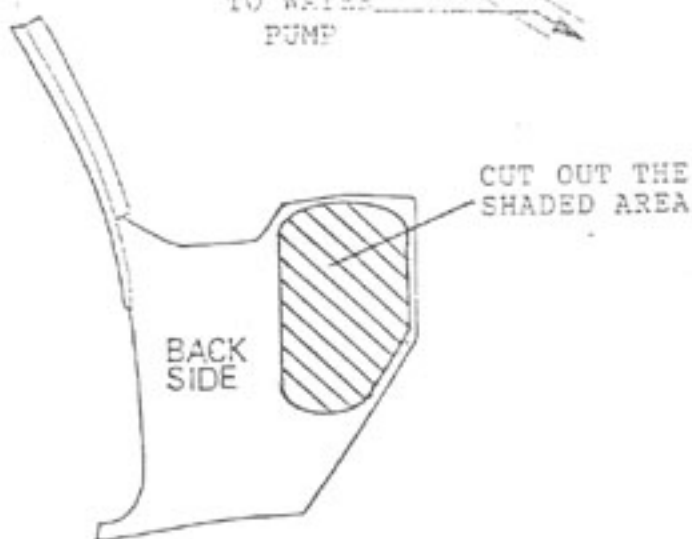

FIGURE 9A

GLOVE BOX INSTALLATION

1. INSTALL NEW GLOVE BOX AS SHOWN IN FIGURE 9B.
2. RE-ATTACH ALL ITEMS PREVIOUSLY REMOVED AT THIS TIME.

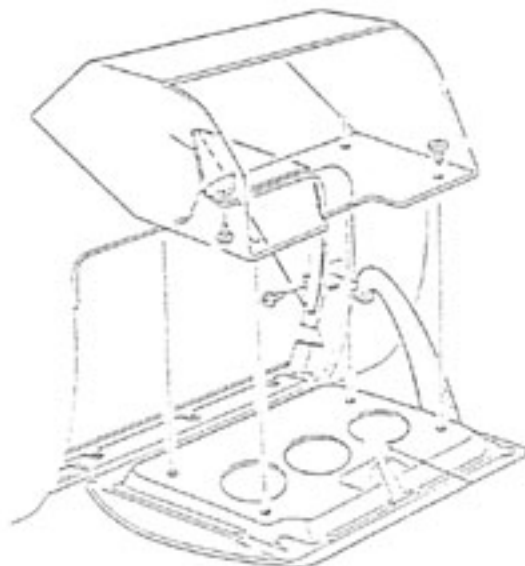

FIGURE 9B

RADIATOR SUPPORT MODIFICATION

1. Drill a 1 1/4" hole in the location shown in Figure 14. A 1/8" pilot hole may need to be drilled to insure proper location of the 1 1/4" hole.
2. After the hole is drilled, insert a rubber grommet (supplied) in both the OEM hole and the new hole.

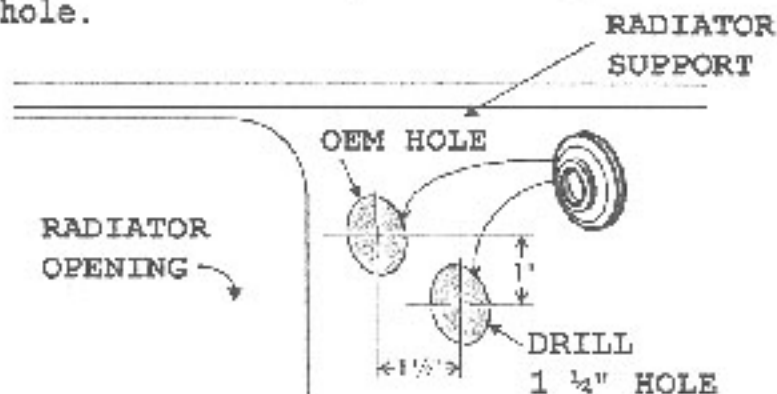

FIGURE 14

OEM CONTROL CABLE INSTALLATION

Attach the OEM control cables using the plastic sleeve and push-on ring (supplied) as Figure 14B shows.

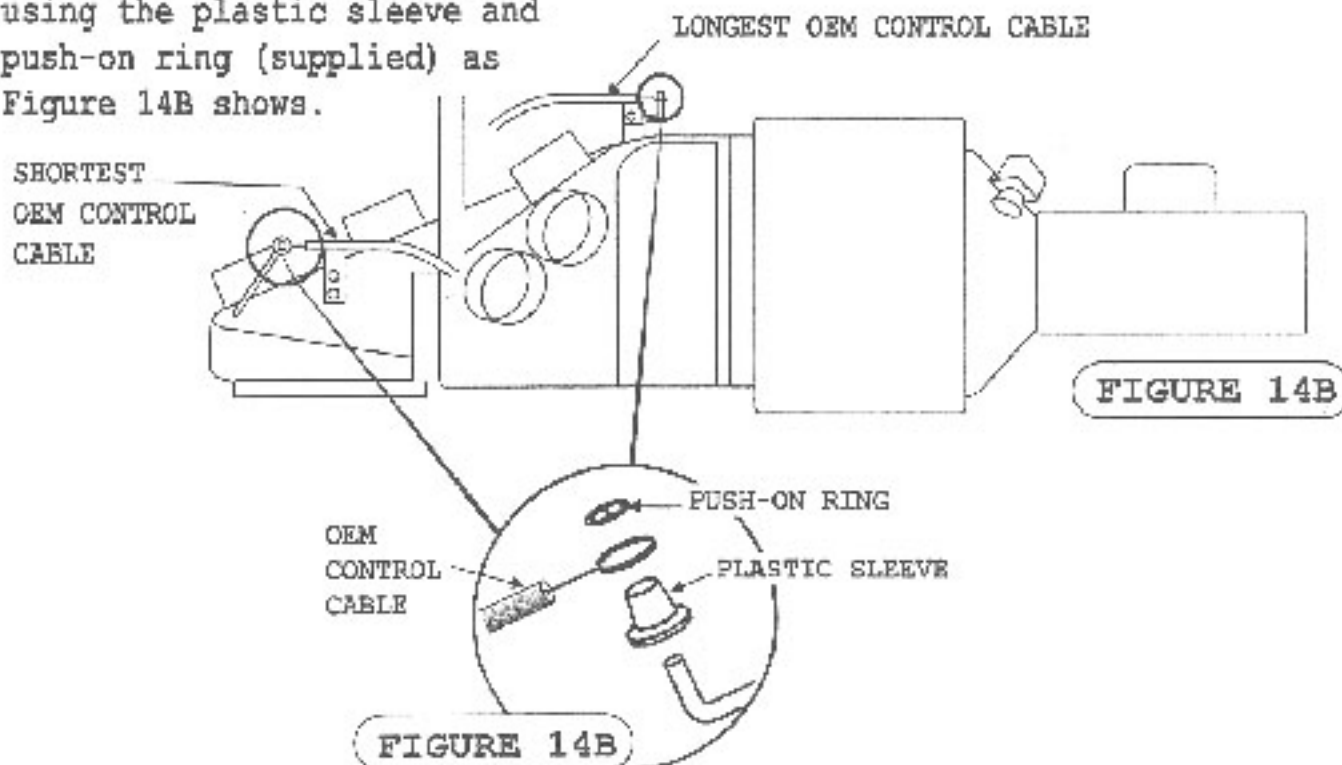

FIGURE 14B

FIGURE 14B

ENGINE COMPARTMENT

COMPRESSOR

1. REFER TO SEPARATE INSTRUCTIONS (INCLUDED WITH COMPRESSOR BRACKET) TO INSTALL COMPRESSOR BRACKET.
2. INSTALL COMPRESSOR AND BRACKET USING HARDWARE INCLUDED WITH BRACKET.

CONDENSER ASSEMBLY INSTALLATION

1. REMOVE HOOD LATCH AS FIGURE 10 SHOWS.

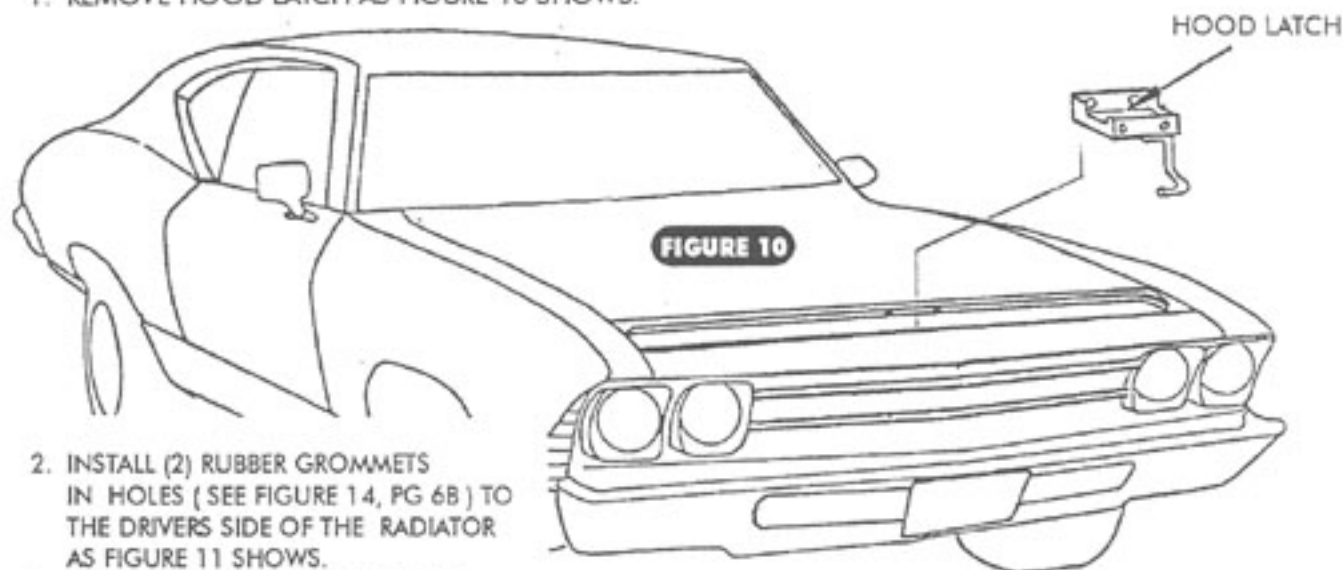

2. INSTALL (2) RUBBER GROMMETS IN HOLES (SEE FIGURE 14, PG 6B) TO THE DRIVERS SIDE OF THE RADIATOR AS FIGURE 11 SHOWS.
3. INSTALL (ATTACH) #6 & #8 HOSES TO CONDENSER, THEN SLIDE CONDENSER BETWEEN RADIATOR AND GRILLE

4. THE CONDENSER ASSEMBLY MOUNTS UNDER THE HOOD LATCH AND LOWER HOOD LATCH SUPPORT BRACE MOUNTING POINT THAT IS BELOW THE RADIATOR (SEE PAGE 8).

5. ONCE THE CONDENSER IS IN PLACE, RE-INSTALL THE HOOD LATCH AND

6. PASS THE #6 & #8 HOSES THRU THE RUBBER GROMMETS PREVIOUSLY INSTALLED IN STEP 2 ON THIS PAGE INTO ENGINE COMPARTMENT.

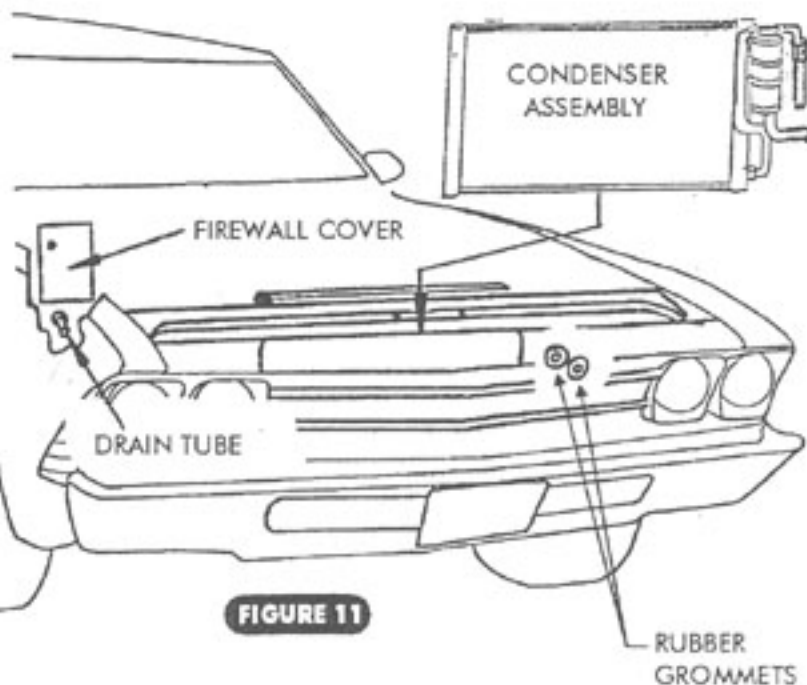
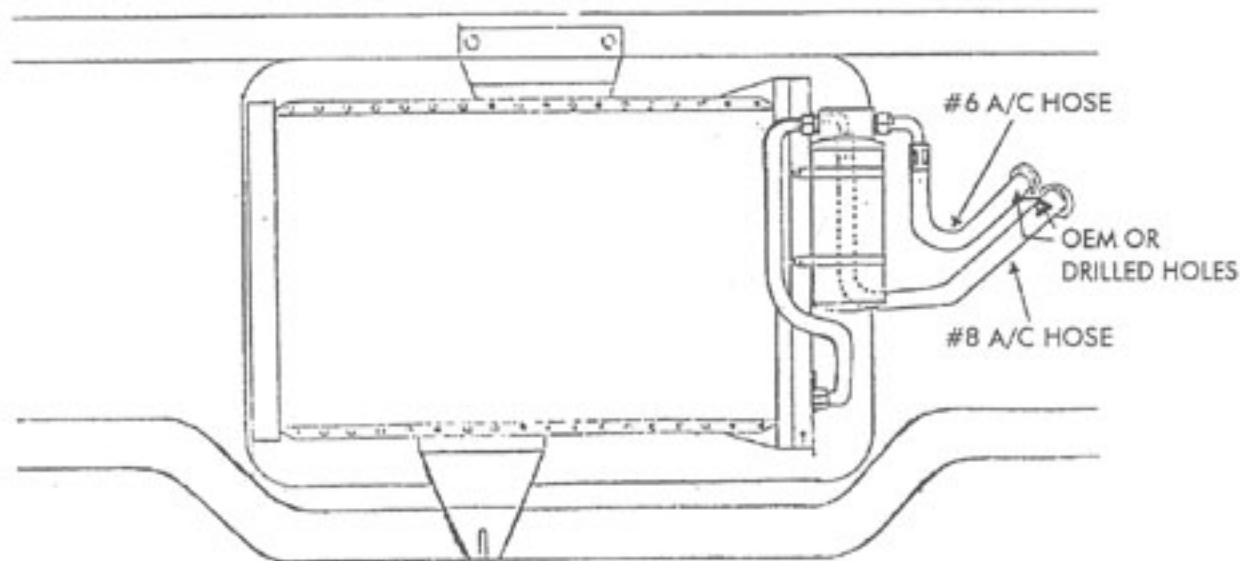
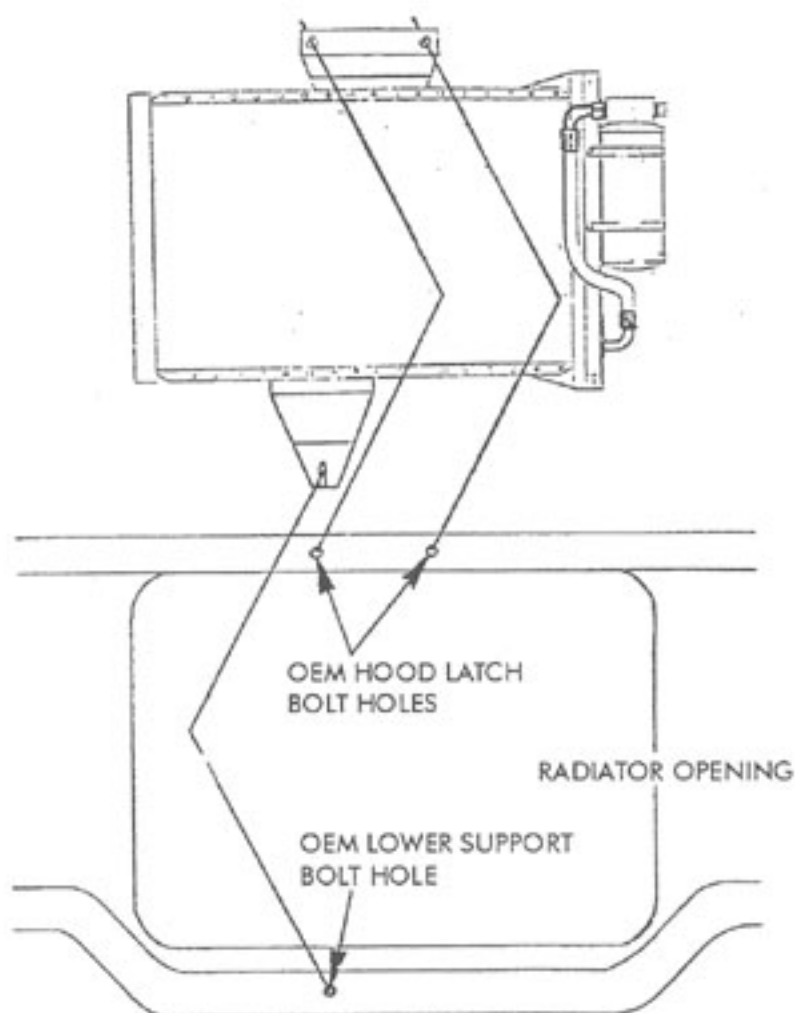

FIGURE 11



REFRIGERATION HOSES (FIGURE 12)

NOTE: PRIOR TO INSTALLING REFRIGERATION LINES, LUBRICATE AND SLIDE THE CORRESPONDING O-RING ON THE FITTING

1. LUBRICATE AND ATTACH #10 SUCTION HOSE TO THE COMPRESSOR (1/2" I.D. HOSE 79" LONG STRAIGHT FEMALE O-RING FITTING ON FIREWALL END AND 135° FEMALE O-RING FITTING ON COMPRESSOR END).
2. LUBRICATE AND ATTACH #8 DISCHARGE HOSE TO THE COMPRESSOR (13/32" I.D. HOSE 45" LONG WITH 90° FEMALE O-RING FITTING ON CONDENSER END AND 135° FEMALE O-RING FITTING ON COMPRESSOR END).
3. LUBRICATE AND ATTACH #6 LIQUID HOSE FROM EVAPORATOR TO DRIER (5/16" I.D. HOSE 115" LONG WITH 90° FEMALE O-RING FITTING ON EVAPORATOR END AND 90° FEMALE O-RING FITTING ON THE DRIER.)

INSTALL HEATER HOSES AND HEATER VALVE AS SHOWN IN FIGURE 9, PAGE 6. INSTALL HEATER CONTROL VALVE IN PRESSURE (INTAKE MANIFOLD) HEATER HOSE LINE.

NOTE: THE HEATER HOSES FOR THIS APPLICATION NEED TO BE 5/8" x 6' EACH (HEATER HOSES ARE NOT SUPPLIED).

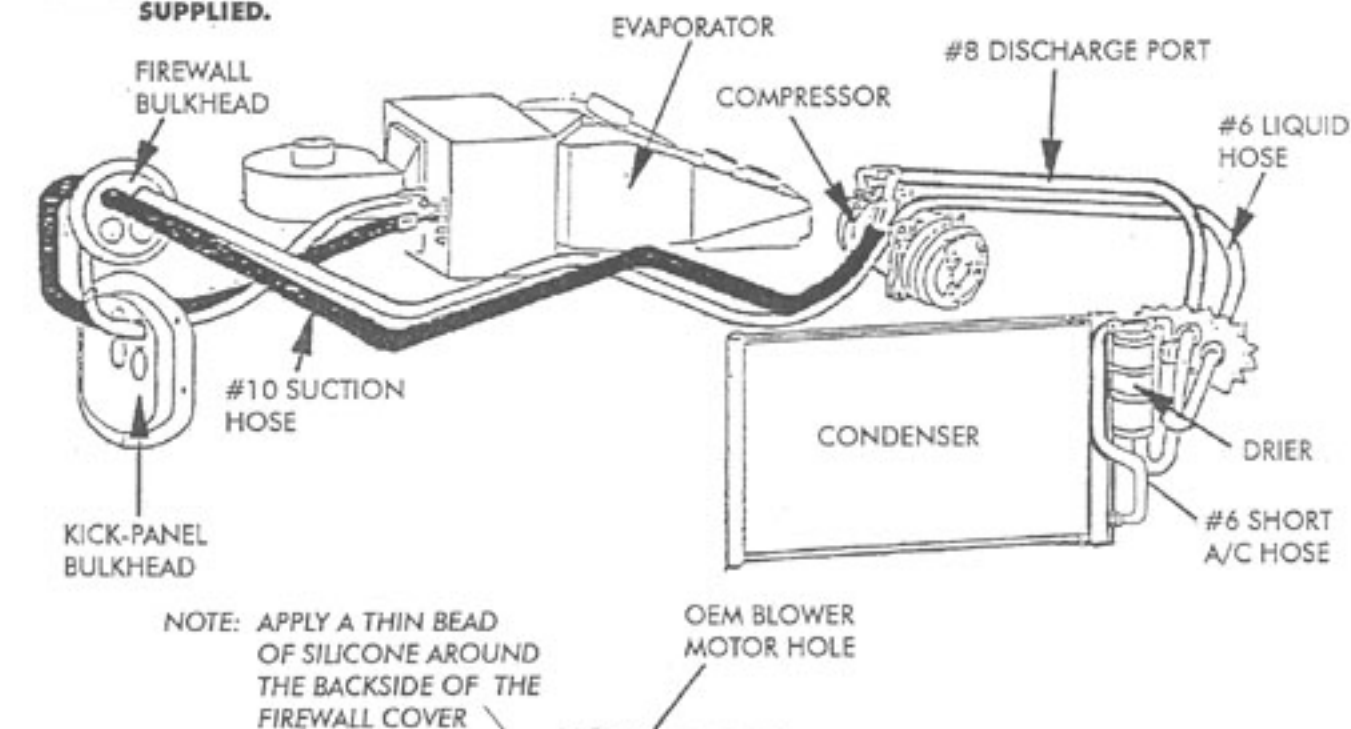
FIGURE 12

YOUR SYSTEM IS READY TO EVACUATE AND CHARGE. THIS SHOULD BE DONE ONLY BY A CERTIFIED AIR-CONDITIONING TECHNICIAN.

RE-ATTACH ALL COMPONENTS IN REVERSE ORDER OF REMOVAL.

OEM CONTROL OPERATION

This application uses the OEM cables and fan switch. Refer to the wiring diagram for instructions on how to hook up the OEM fan switch. Refer to the OEM CONTROL CABLE INSTALLATION diagram for OEM control cable installation.

HEAT

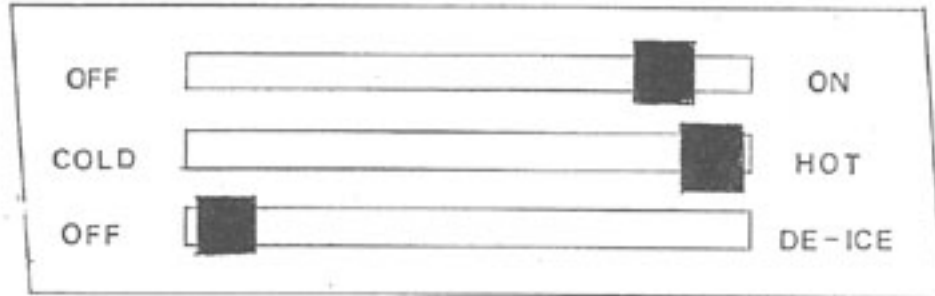

DEFROST

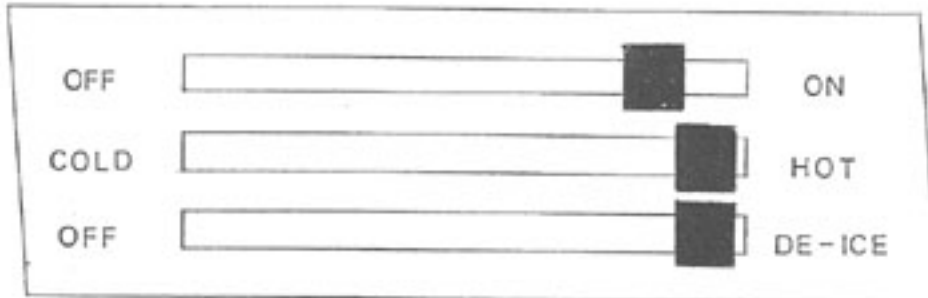

A/C

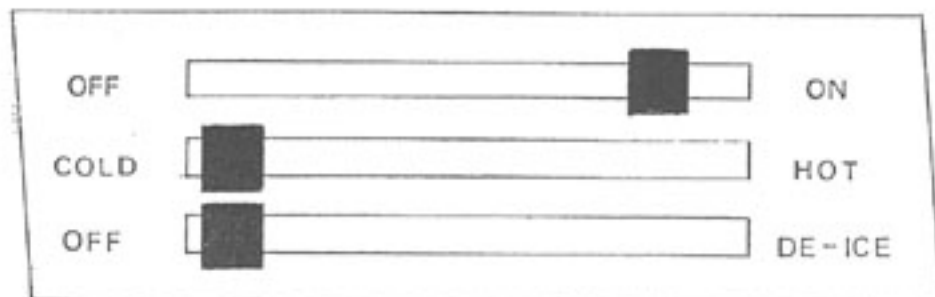

WIRING DIAGRAM
'68-70 CHEVELLE
w/OUT FACTORY AIR

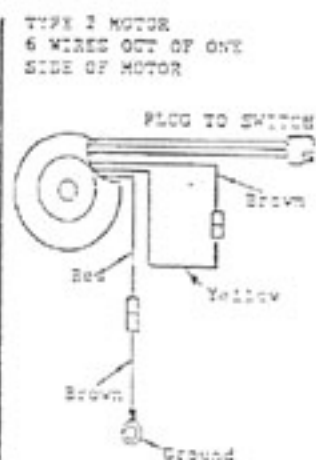
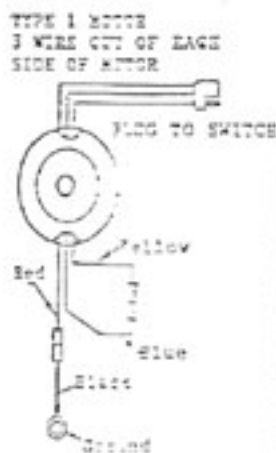
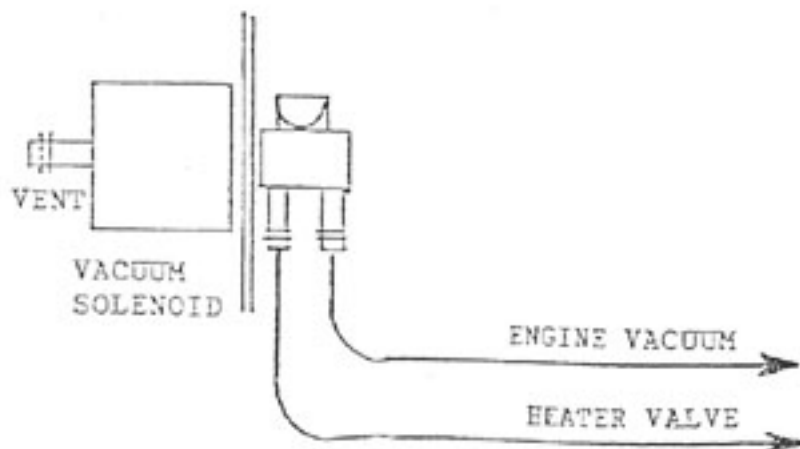
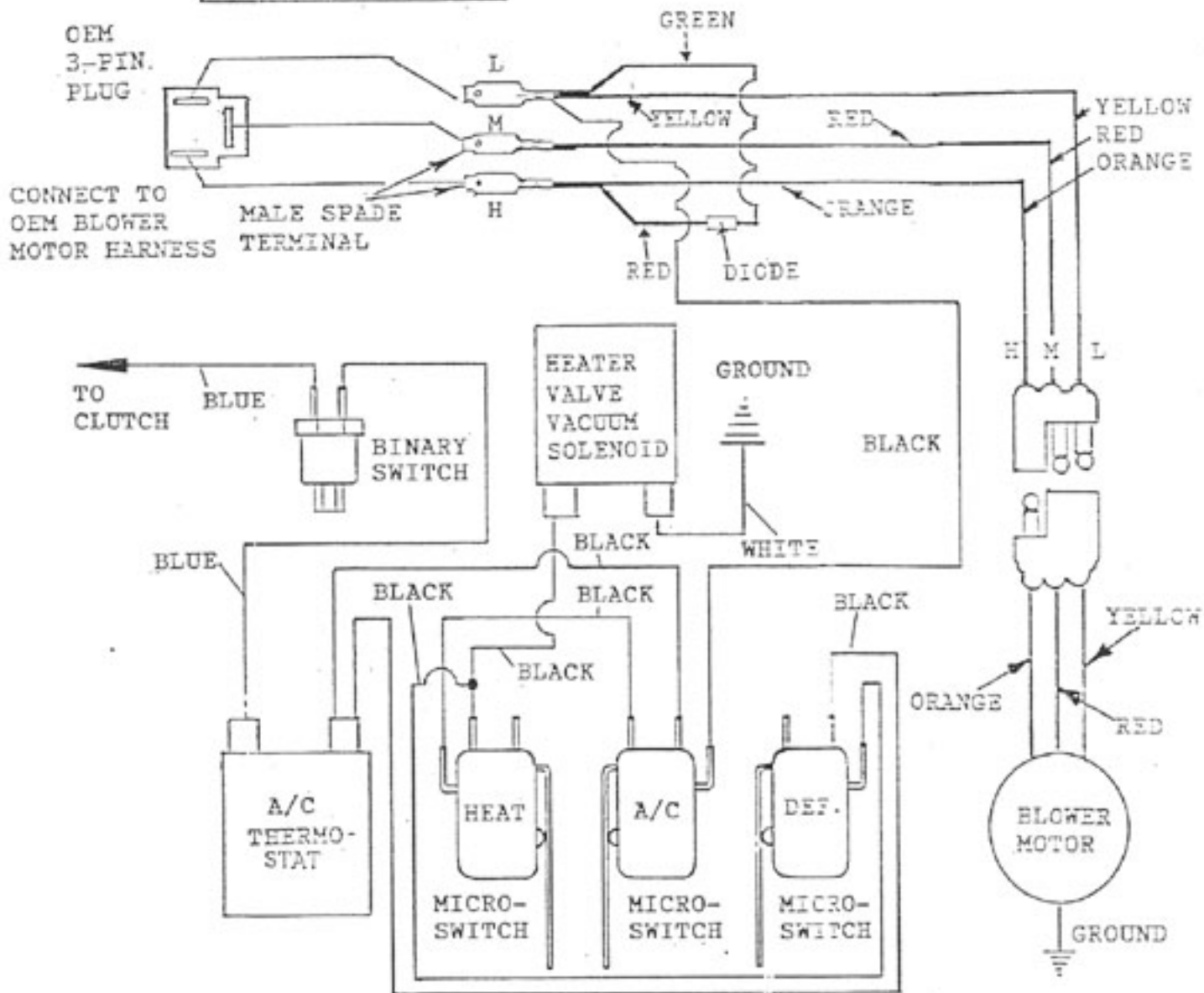

1968-70 CHEVELLE WITHOUT FA EVAPORATOR KIT PACKING LIST

EVAPORATOR KIT 55069-VCZ-A

No.	QTY.	PART No.	DESCRIPTION
1.	1	55369-VCE-A	EVAPORATOR SUBCASE
2.	1	78169-ACN	1968-70 CHEVELLE W/O AC ACCESSORY KIT

CHECKED BY: _____
 PACKED BY: _____
 DATE: _____

①

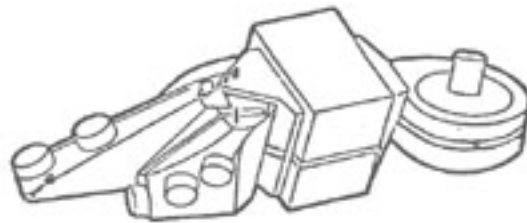

②

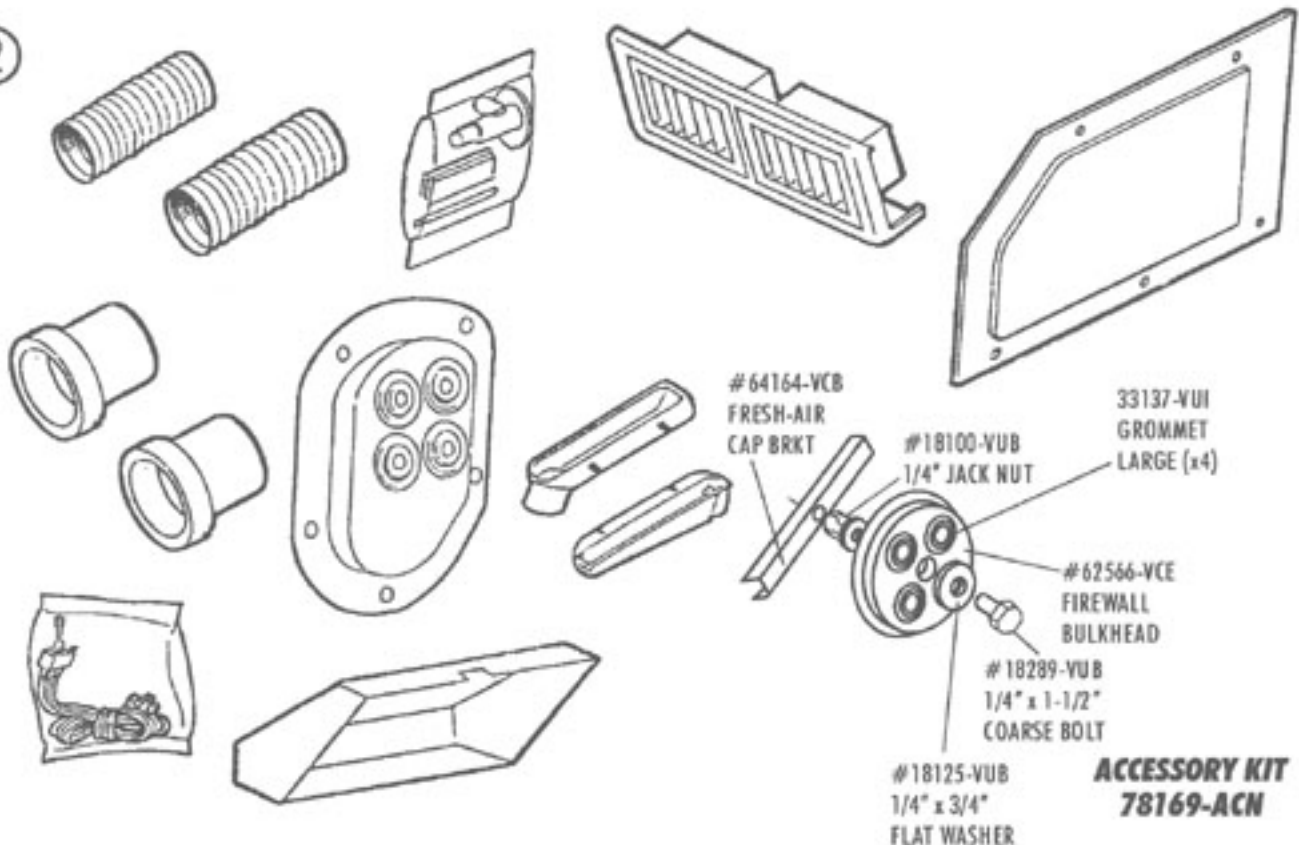

1968-70 CHEVELLE WITHOUT FA ACCESSORY KIT PACKING LIST

EVAPORATOR KIT 78169-ACN

No.	QTY.	PART No.	DESCRIPTION
1.	6'	06200-VUE	2" DUCT HOSE
2.	6'	06250-VUE	2½" DUCT HOSE
3.	5	18100-VUB	¼" JACK NUT
4.	1	18125-VUB	¼" x ¾" FLAT WASHER
5.	1	18289-VUB	¼" x 1½" COARSE BOLT
6.	8	33137-VUI	GROMMET LARGE
7.	1	64164-VCB	FRESH-AIR CAP BRACKET
8.	2	49256-VUL	3-½" x 1-½" LOUVER
9.	2	49870-VCI	HOSE ADAPTER OEM LOUVER
10.	1	62267-VCE	FIREWALL COVER
11.	1	62565-VCE	KICK-PANEL BULKHEAD
12.	1	62566-VCE	FIREWALL BULKHEAD
13.	1	62567-VCE	GLOVE BOX
14.	1	62572-VCE	CENTER VENT
15.	1	63262-VCE	68-70 CHEVELLE W/O AC INSTALL. KIT
16.	1	63382-VCE	DEFROST DUCT ASSEMBLY

CHECKED BY: _____
 PACKED BY: _____
 DATE: _____

